

# IN3900 (SERIES)

**InFocus**  
Bright Ideas Made Brilliant



The smart alternative  
to interactive whiteboards.

Interactive learning just got more affordable.

# IN3900 (SERIES)

## IN3900 Series Interactive Projector

These short throw projectors with breakthrough LiteBoard™ interactive technology let teachers and other professionals interact with the projected image – turning any surface into an engaging, collaborative interactive workspace.

It's like an interactive whiteboard without the board.

### Use wand as a mouse to draw, write and click

Control all your favorite PC or Mac applications with the wireless LiteBoard Wand just as you would with your mouse.

- The LiteBoard Wand has left-click and right-click buttons, a scroll wheel, and more
- Draw and annotate on the visuals you're projecting
- Quickly undo your markups with the wand's Undo button
- Easily advance and reverse your presentation slides
- No special software is needed: it works with the software you use today

### Interact up close or away for maximum accessibility

Anyone can participate and interact because they don't need to touch the image – just point and click the wand. You can't do that with an interactive whiteboard.

- Teachers can interact with the images while out in the class with the students
- Ordinary business meetings turn into collaboration sessions
- People of any height, including wheelchair users, can interact with all parts of the image
- The visually-impaired benefit from ultra-large images



Hold the wand like a pen for drawing or writing, or hold it like a remote control – whichever is more comfortable.



### The LiteBoard Wand

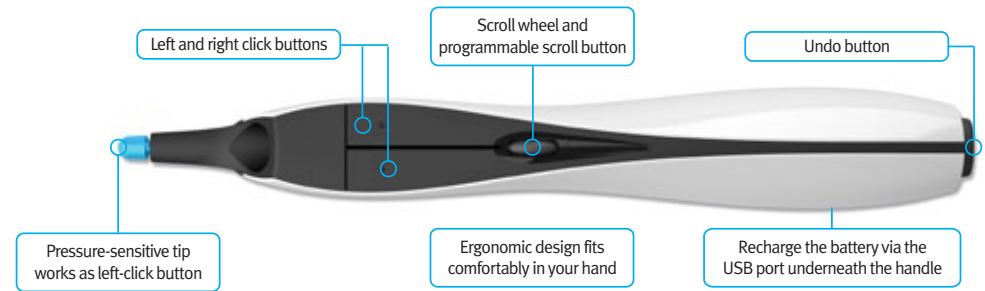

### Compare to an interactive whiteboard

	IN3900 Series	Interactive Whiteboard
<b>Interaction</b>	At the image or away	At the image only
<b>Accessibility</b>	Touch is not required so the entire image is accessible to anyone	Top of the image can be hard to reach
<b>Image size (Diagonal)</b>	Up to 150"/3.81 m wide	Up to 82"/2.1 m wide
<b>Cost</b>	One low-priced projector is all you need	High cost for a board and a projector
<b>Size and mobility</b>	Easily move or install	Big and hard to move
<b>Calibration</b>	None	Required
<b>Drivers</b>	None	Required

### Connect your collaboration and classroom tools

Easily connect your PC or Mac, DVD player, or document reader via a multitude of inputs. The IN3916 model even lets you present from a USB thumb drive and includes HDMI, networking (LAN), and RS232 ports.

- Display over USB port sends audio and video in one cable (IN3916 only)
- IT administrators can control the projector remotely via the LAN port (IN3916 only)
- Connect wirelessly with optional 802.11 b/g wireless module (IN3916 only)

### Room-filling audio

Get your message across from the front row to the back with the IN3900 projector's clear and powerful audio system – one of the best you'll hear in this price range.

- Integrated 20-watt stereo speakers (2 × 10 w)
- Preserve your voice with dedicated dynamic microphone input
- Narration feature lets your voice be heard over the audio of your presentation/video
- Advanced audio processor shapes the sound for best performance

### Minimal shadow interference

Get big images when the IN3900 short throw projector is close to the wall to reduce shadows, free up space and reduce ambient noise.

- Project a 5 feet (1.5 m) wide interactive image from only 2.6 feet (0.8 m) away (IN3916 model)
- Interact with an image that can be up to 150" (3.8 m) wide (diagonal)
- Install on wall or ceiling or place on a tabletop or media cart
- Display 3D video and images created in the top emerging 3D standards

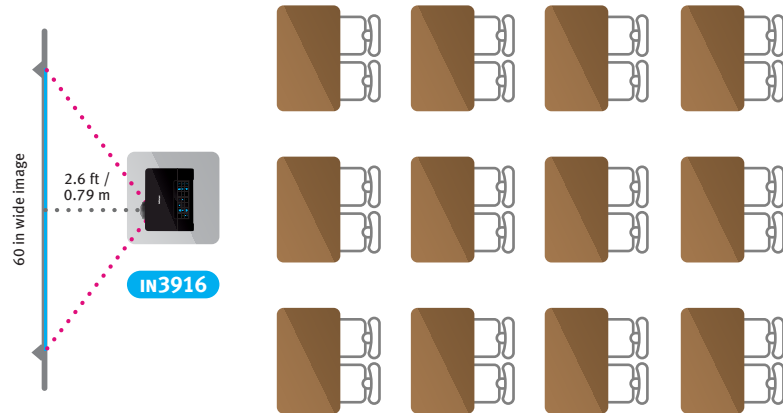

“... As transformative for education as early interactive boards were – maybe more.”

– Scholastic Administr@tor Tech Tools



IN3916 Back Panel

### Software that makes interacting easy and fun

- Education version includes drawing, math, geography, literacy and curriculum-building tools
- Business version includes annotation, productivity and screen capture tools
- Works on top of your web browser and other favorite applications
- PC and Mac compatible



WizTech InFocus Edition software

### Control the display of multiple PCs

A presenter or teacher can connect up to 32 computers to one projector (via a network or optional wireless connection) and control who presents from one web page.

- Connect up to 32 computers and select the one(s) you want to project
- Display up to 4 computer screens simultaneously
- Works with the IN3916 only

Computer Name	Play Control	IP Address
sbailey	1 2 3 4	192.168.3.101
mkruger	1 2 3 4	192.168.3.117
rkent	1 2 3 4	192.168.3.142
rdeiwie	1 2 3 4	192.168.3.125
dbaldoni	1 2 3 4	192.168.3.098
rburdick	1 2 3 4	192.168.3.104
lokerle	1 2 3 4	192.168.3.057
sneisen	1 2 3 4	192.160.3.150



Moderator control panel

Project up to 4 computer screens at the same time

# Specifications\*

IN3914

IN3916

Resolution (native)	XGA 1024 × 768	WXGA 1280 × 800
LiteBoard Wand	Standard	
Brightness	2700 lumens	
Connections (Input)	VGA × 2, Composite, RCA audio, 3.5 mm (mic), 3.5 mm (audio)	
Connections (Output)	Monitor out: VGA, Variable audio out: 3.5 mm, Power out: 5V × 2 amp (for accessories)	HDMI 1.3, USB (for display), USB (for wireless LAN or USB thumb drive), LAN
Control	RS232, USB mini-B	Wireless-ready Port via USB for 802.11b/g dongle RS232, USB mini-B, LAN (RJ-45)
Aspect ratio (native)	4:3	16:10
Throw ratio	0.61:1	0.52:1
Image size (width)	48.4 - 106.3" (1.23 - 2.7 m)	56.7 - 124.8" (1.44 - 3.17 m)
Image offset	7.5 %	2.5 %
Power consumption	280 watts (Eco Mode); 330 watts (Bright); < 1 watt (Standby)	300 watts (Eco Mode); 350 watts (Bright); < 1 watt (Standby)
Audio	20 w (2 × 10 w), voice and multimedia modes	
Warranty	5 Years	
Standard accessories	VGA cable, Remote control, Wand Kit (includes LiteBoard Wand, wand dock, power charger and USB cables), WizTeach InFocus Edition software	

## Optics

Maximum contrast ratio: 3200:1  
Supported aspect ratio: 4:3, 5:4, 16:9, 16:10  
Zoom ratio: 1.35× (Digital)  
Projection distance: 29.5 - 65" (0.75 - 1.65 m)  
Projection methods: Front, ceiling, rear  
Keystone correction: ±30%  
Video compatibility: 480i/p, 576i/p, 720p, 1080i/p,  
NTSC/NTSC4.43/PAL/PAL-M/PAL-N/SECAM  
H-Synch range: 31.4 - 91.1 KHz  
V-Synch range: 23.5 - 85 Hz  
3D projector: Yes

## LiteBoard Wand

Wand operation: Up to 40 ft. (12 m) from projector, 45° pen to image angle  
Battery: ~40 hours life on full charge, rechargeable via USB using included power supply or other USB power source

## Operation

Lamp life: 4000 hours (Eco Mode), 2500 hours (Bright)  
Lamp power: 2700 lumens, 220 watts  
Power supply: 90 - 264 VAC, 50/60 Hz  
Audible noise: 30 dB (Eco Mode), 35 dB (Bright)  
Operating temperature: IN3914: 5 - 40° C; IN3916: 5 - 35° C  
Altitude (max): 7500 ft at 104° F (2286 m at 40° C),  
10000 ft at 95° F (3048 m at 35° C)  
Menu languages: Danish, Dutch, English, Finnish, French,  
German, Italian, Korean, Norwegian, Polish, Portuguese,  
Russian, Simplified Chinese, Spanish, Swedish, Traditional  
Chinese, Turkish

## Physical

Product dimensions: 5 × 12.6 × 9.9" (125 × 320 × 251 mm)  
Product weight: 9.9 lbs (4.5 kg)  
Shipping dimensions:  
IN3914: 16.3 × 11.2 × 15.2" (415 × 285 × 387 mm),  
IN3916: 18.7 × 11 × 15" (476 × 281 × 383 mm)  
Shipping weight: IN3914: 13 lbs (5.9 kg),  
IN3916: 14.5 lbs (6.6 kg)  
Security: Kensington® lock  
Lamp (particle) containment:  
Tested to contain particles larger than 0.8 mm  
Approvals: UL & CUL (USA and Canada), FCC (USA), CE (Europe),  
C-Tick Mark (Australia), NOM & COFETEL (Mexico)

## Warranty

Product warranty: 5 years limited  
Lamp warranty: 6 months  
Accessory warranty: 90 days

## System Requirements

LiteBoard: OS compatibility: Windows (XP, Vista, 7), Mac, Linux  
USB display (IN3916 only): OS compatibility: Windows (XP Service Pack, Vista 32/64 bit, Win 7 32/64 bit)  
LAN display, WiFi display, Quad View display (IN3916 only): OS compatibility: Windows (XP Service Pack, Vista 32/64 bit, Win 7 32/64 bit), Mac (10.4 and higher)  
LitePort USB thumb drive port (IN3916 only):  
USB 2.0/1.1, JPEG or PtG file  
Presentation to Go (PtG) Converter (IN3916 only):  
Pentium-M1.5G or higher, Windows (XP Service Pack, Vista 32/64 bit, Win 7 32/64 bit), MS Office 2003 or 2007

## Optional Accessories

Replacement Lamp (SP-LAMP-062)  
Universal Ceiling Mount (SP-CEIL-UNIV)  
Wall Arm (SP-WALLARM-01)  
LiteBoard Wand Kit (HW-LBWAND-01)  
802.11 b/g Wireless Module (SP-WIFIUSB)  
DisplayLink Extender (SP-DOUSB-EXTENDER)  
Cables & Adapters  
Extended warranties  
Alternate remote controls

For more information, visit:  
[www.infocus.com/Accessories.aspx](http://www.infocus.com/Accessories.aspx)

## Warranty

The IN3900 interactive projector series comes standard with a 5-year limited factory warranty (including parts<sup>1</sup> and labor<sup>2</sup>), a 6-month limited lamp replacement warranty and a 5-year DLP warranty. Extended product and lamp warranty programs are also available.

For more information, visit:  
[www.infocus.com/Support/Warranty.aspx](http://www.infocus.com/Support/Warranty.aspx)



**LiteBoard™**  
interactive

**InFocus**  
Bright Ideas Made Brilliant